

# INTERNI

with complete english text

**Hotel di design nel mondo**  
design-oriented hotels in the world

**Tavoli, sedie, imbottiti e tessuti in movimento**  
Tables, chairs, upholstery and fabrics in motion

**David Carson: il segno dei tempi**  
the sign of the times







1

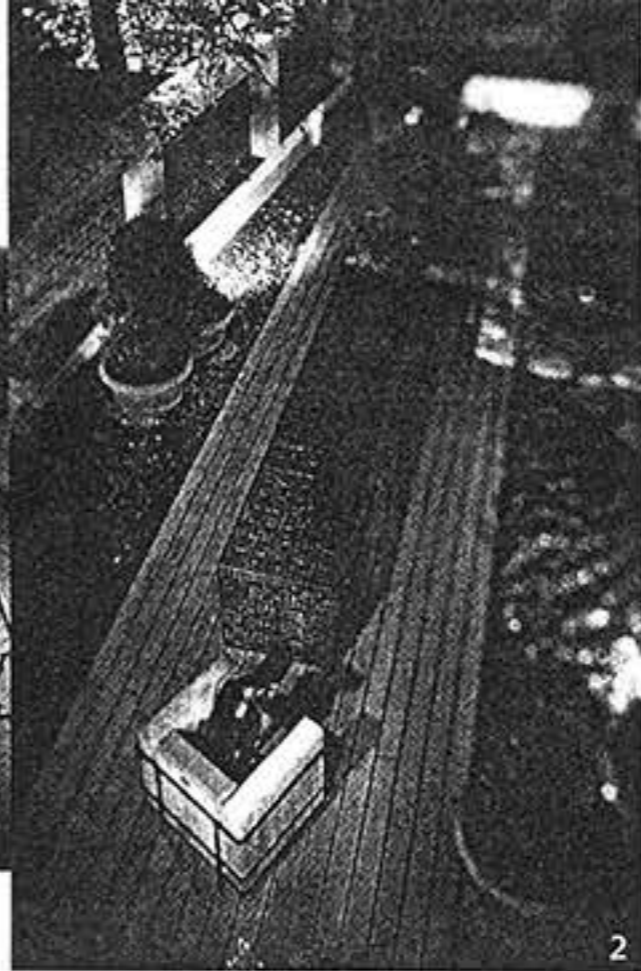

2

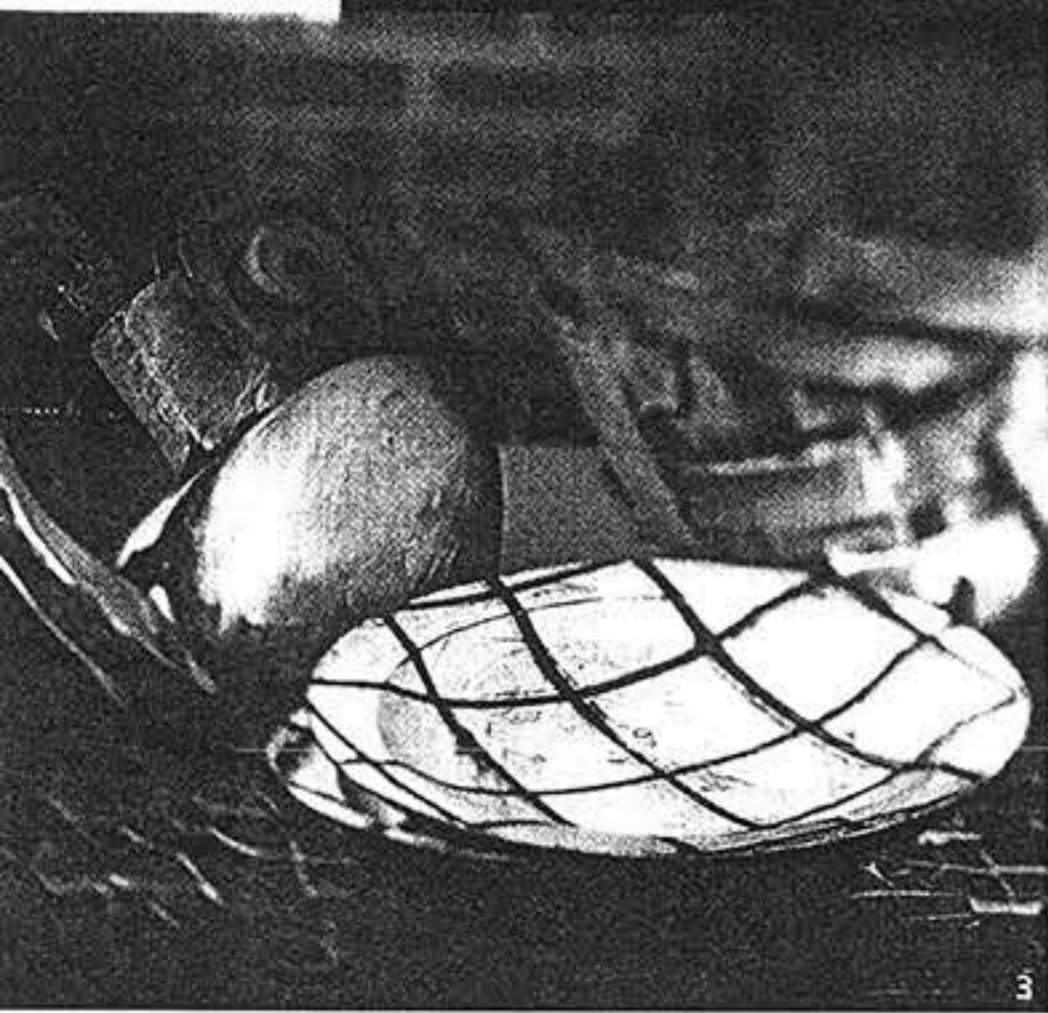

3

*von Brevern make one corner of the restaurant more poetic.*

**4** Mensola porta-libri, in una rappresentazione in legno dell'Atelier Weinand.

*Bookshelf in a representation in wood by Atelier Weinand.*

**5** Sulle scale, appesa alla parete, un'opera di Elvira Bach.

*On the wall of the stairs, a work by Elvira Bach.*

**6** Blaue Treppe, una scultorea scala realizzata da Katia Hajek, collocata nel secondo cortile dell'albergo. Blaue Treppe, a sculptural staircase by Katia Hajek, in the second courtyard of the hotel.

**7** Un'installazione di Rosemarie Sansonetti, tra il negozio e il Blue Bar. An installation by Rosemarie Sansonetti, between the shop and the Blue Bar.

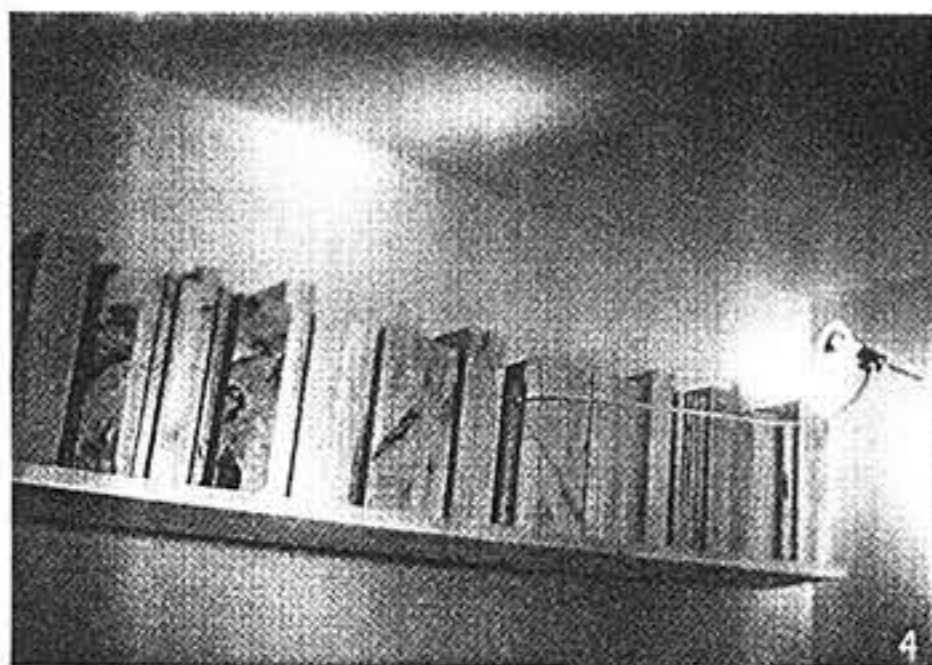

4



5

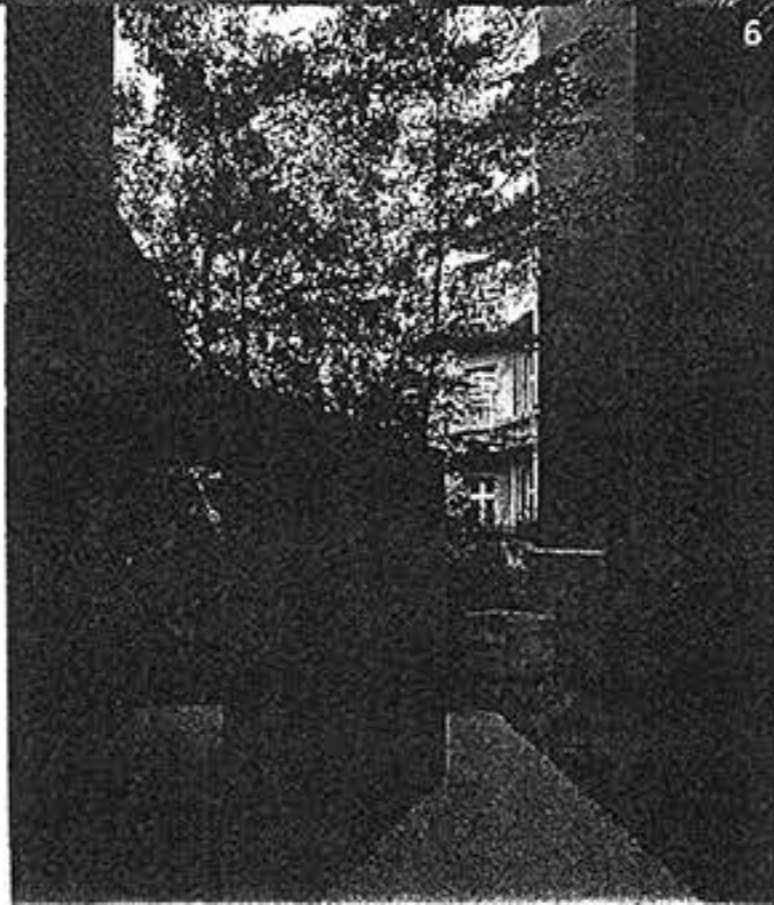

6



7